

FaceStation F2

Fusion Multimodal Terminal



Unrivaled
Face Recognition
Performance



Best-in-class
Multimodal Device



Contactless Solution
for the New Normal



Robust Device Security and
Data Encryption



Unrivaled face recognition performance by Fusion Matching

FaceStation F2 boasts exceptional authentication accuracy achieved by the fusion matching of visual and infrared(IR) face recognition.

*False Acceptance Rate(FAR) of 1 in 10 billion.



- Suprema's unique algorithm optimizes IR and visual face recognition to produce the industry's best face recognition and anti-spoofing performance
- Proven track record of authentication performance regardless of user ethnicity and face changes powered by deep learning algorithm

Best-in-class multimodal with various credentials

FaceStation F2 offers a wide range of authentication options including face, mobile access, fingerprint and cards.



Face



Mobile Access



Fingerprint



Card

- Register up to 100,000 users for fingerprints authentication and 50,000 users for face authentication
- Supports dual frequency access cards, NFC and BLE-based Mobile Access Cards
- Access-on-card allows authentication via biometric data stored in cards



Contactless solution for new standards of safety and hygiene

FaceStation F2 meets the needs of the post-pandemic world with remote and contactless solution.

- Detects and limits access of users not wearing masks
- Face recognition of users wearing masks
- Remote user enrollment through profile photo uploads
- Combines with Suprema Thermal Camera to identify users with elevated skin temperature

Robust device security and data encryption

FaceStation F2 is equipped with security measures to protect user data.

- Highest level of device security including secure booting process
- Encrypts all biometric credentials and personal information
- Built on Android and all its security enhancements



System Configurations

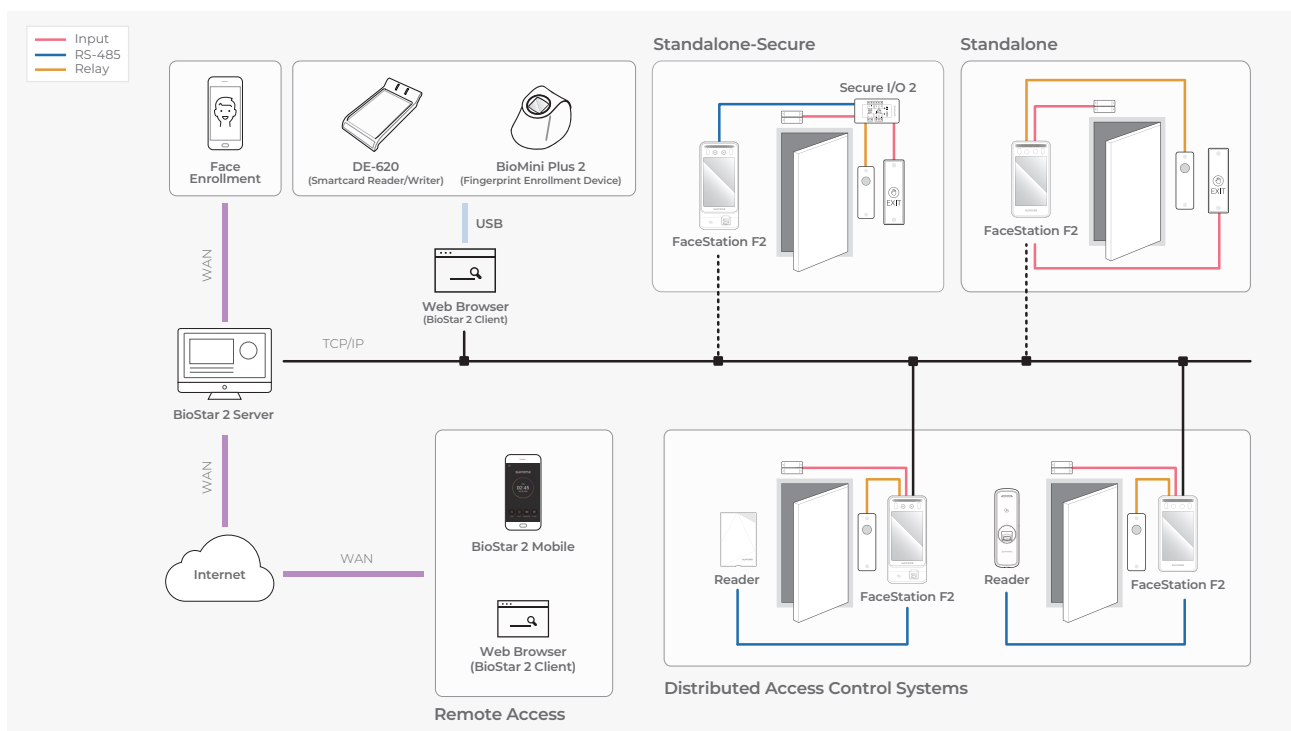

FaceStation F2

Fusion Multimodal Terminal

Product Specification



| Category | Feature | FSF2-DB | FSF2-AB | FSF2-ODB | |
|--------------|---|---|--|---|------|
| Credential | Biometric | Face | | Face, Fingerprint | |
| | RF Option | 125kHz EM & 13.56MHz MIFARE, MIFARE Plus, DESFire EV1/EV2, FeliCa | 125kHz EM & 13.56MHz MIFARE, MIFARE Plus, DESFire EV1/EV2, FeliCa, iCLASS SE/SR/Seos | 125kHz EM & 13.56MHz MIFARE, MIFARE Plus, DESFire EV1/EV2, FeliCa | |
| | RF Read Range* | EM/MIFARE/DESFire : 50 mm (2"), FeliCa: 30 mm (1.2") * RF read range will vary depending on the installation environment | | | |
| | Mobile | NFC, BLE | | | |
| General | CPU | 1.8 GHz Dual Core + 1.4 GHz Quad Core | | | |
| | Memory | 16GB Flash + 2GB RAM | | | |
| | LCD Type | 7" IPS color LCD | | | |
| | LCD Resolution | 800 x 1280 pixels | | | |
| | Sound | 16bit | | | |
| | Operating Temperature | -20°C ~ 50°C (-68°F ~ 122°F) | | | |
| | Operating Humidity | 0% ~ 80%, non-condensing | | | |
| | Dimension (W x H x D) | 119.8mm x 223mm x 23.5mm (4.7" x 8.8" x 0.9") | | 119.8mm x 268.4mm x 49.7mm (4.7" x 10.6" x 1.9") | |
| | Weight | Device | 585g | | 670g |
| | | Bracket (Including washer and bolt) | 181g | | 205g |
| | IP Rating | IP65 | | | |
| Certificates | CE, FCC, KC, RoHS, REACH, WEEE | | | | |
| Face | Recognition Distance | 0.5m ~ 1.3m (19.7" ~ 51.2") | | | |
| | Recognition Height | 140cm ~ 190cm (55.1" ~ 74.8") | | | |
| | Matching Speed | Less than 0.5 sec | | | |
| | Live Face Detection (Anti-Spoofing) | Supported | | | |
| Fingerprint | Image Dimension | N/A | | 300 x 400 pixels | |
| | Resolution | | | 500 dpi | |
| | Template | | | SUPREMA / ISO19794-2, ANSI-378 | |
| | Extractor / Matcher | | | MINEX certified and compliant | |
| | Sensor Certificates | | | FBI PIV and FBI Mobile ID FAP20 | |
| | Live Fingerprint Detection | | | Supported (SW-based) | |
| Capacity | Max. User (1:1) * Based on one face/fingerprint enrollment per user | 100,000 | | | |
| | Max. User (1:N) * Based on one face/fingerprint enrollment per user | Face: 50,000 | Face: 50,000 Fingerprint: 100,000 | | |
| | Max. Text Log | 5,000,000 | | | |
| | Max. Image Log | 50,000 | | | |
| Interface | Ethernet | 10/100 Mbps, auto MDI/MDIX | | | |
| | RS-485 | 1ch Host or Slave (Selectable) | | | |
| | Wiegand | 1ch Input, 1ch Output | | | |
| | TTL Input | 2ch Inputs | | | |
| | Relay | 1 Relay | | | |
| | USB | USB 2.0 (Host) | | | |
| | Tamper | Supported | | | |
| Power | Voltage: DC 12V ~ DC 24V Current: Max. 2.5 A * Use a 24V/2.5A adapter. Must follow the product manual when using a 12V adapter. | | | | |